

# INSTALLATION INSTRUCTIONS

**Product: Control Arm Correction Brackets**  
**Part Number: JKS6200**

**Applications: Jeep Wrangler JK, 2007-14**

517-278-1226 • tech@jksmfg.com • www.jksmfg.com  
491 W. Garfield Avenue, Coldwater, MI 49036



## Welcome

Thank you for purchasing Control Arm Correction Brackets from JKS Manufacturing. We are committed to providing you with the best products available and your satisfaction is our first priority.

PLEASE READ these Installation Instructions carefully, and save them for future reference, as they contain important installation and maintenance information.

## Important

*Intended for installation on vehicles already lifted a minimum of 2". Vehicle must be equipped with a minimum of 2" of additional bump stop (JKS1120).*

## Tools Required

- Metric Socket Wrench Set
- Torque Wrench

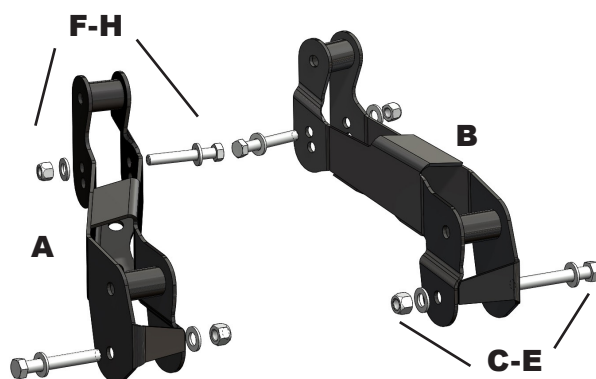

## Parts

	Description	QTY
<b>A</b>	Control Arm Correction Bracket - Drv	1
<b>B</b>	Control Arm Correction Bracket - Pass	1
	Bolt Pack J109	1
<b>C</b>	14mm x 100mm bolt	2
<b>D</b>	14mm flat washer	4
<b>E</b>	14mm lock nut	2
<b>F</b>	12mm x 80mm bolt	2
<b>G</b>	12mm flat washer	4
<b>H</b>	12mm lock nut	2

## Installation

**INSTALLATION OF THESE BRACKETS IS BEST PERFORMED WITH THE VEHICLE ON THE GROUND TO LIMIT AXLE MOVEMENT WHEN DISCONNECTING THE CONTROL ARMS.**

**2007-2011 models with 3.8L engine: To remove the passenger side UCA bolt from the chassis, it will be necessary to raise the engine according to the following instructions.**

- ➔ Position a second hydraulic jack beneath mounting flange of engine oil pan. Support engine using a suitable block of wood (2x4 or larger) to distribute weight across oil pan bolts. **DO NOT** attempt to lift the engine by engine oil pan.
- ➔ Carefully raise the hydraulic jack just enough to remove the weight of the engine from the engine mounts.
- ➔ Locate the passenger side engine mount bracket and remove the four (4) bolts that secure it to the engine block.

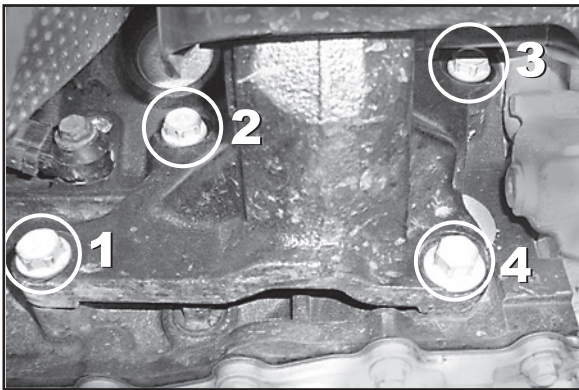

- ➔ Slowly raise the hydraulic jack approximately 1-2 inches until the passenger side control arm bolt clears the interfering exhaust pipe.
- ➔ Continue following instructions with engine in raised position and begin bracket installation.

### ❑ 1. INSTALLATION

- Park the vehicle on a clean, flat surface and block the wheels for safety.
- Working on one side at a time, remove the upper and lower control arm mounting bolts at the frame. Loosen the bolts at the axle, but do not remove.
- Install the control arm drop brackets at shown using the factory hardware. Torque lower bolt to 125 ft-lbs. Torque upper bolt to 75 ft-lbs.

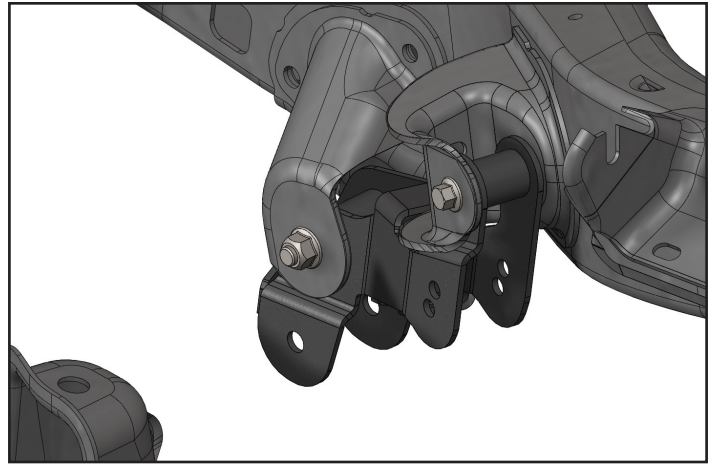

- Mount the lower control arm to the drop bracket using the provided 14mm hardware. Install the bolt from the outside in.
- Mount the upper control arm with the provided 12mm hardware. Install the bolt from the inside out. Use the upper hole for 2"-3.5" lifts and the lower hole for 4"+ lifts.

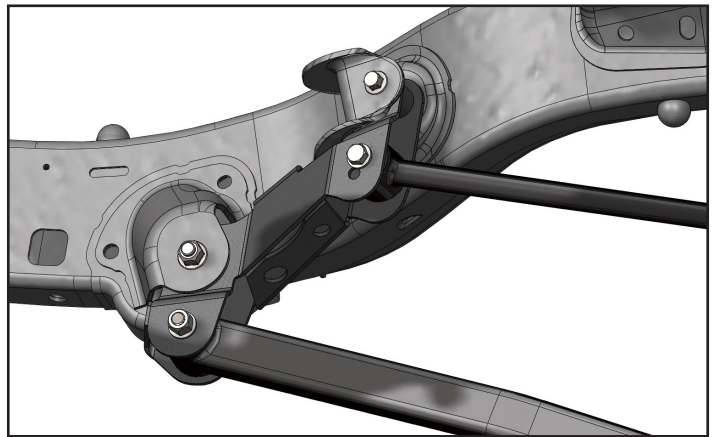

**Note:** It may be easier to align the control arms to the mount by removing the opposite side upper control arm and adjusting the axle with a hydraulic jack.

- Repeat installation on other side of the vehicle.
- Torque the lower control arm bolts to 125 ft-lbs.
- Torque the upper control arm to bracket and to axle bolts to 75 ft-lbs.

## Maintenance

Check hardware torque after 500 miles.

©2014 JKS Manufacturing, Inc & Aftermarketing, LLC  
Revision Date 08/14/2014